

U. S. Department of Labor

Mine Safety and Health Administration
100 Bluestone Road
Mount Hope, WV 25880-1000



MAR 23 2005

Mr. Bill Potter
President
Performance Coal Company
P. O. Box 69
Naoma, WV 25140

Dear Mr. Potter:

Subject: Approved Gas Well Permit, Section 75.1700, 30 CFR 75,
Upper Big Branch Mine-South, I.D. No. 46-08436,
Performance Coal Company, Montcoal, Raleigh County,
West Virginia, Permit No. 17325-T3

This will acknowledge receipt and approval of the subject permit for extracting coal and the request to mine through gas well No. POC 2AA located on the subject mine property.

The permit is based upon an evaluation of the projected mine plan as shown on Form OG-45 dated February 21, 2005, which shows the well being plugged in accordance with the approved 101(c) Petition of Modification and is issued in accordance with provisions of Section 75.1700, 30 CFR.

Should you have any questions concerning this matter, please contact William L. Ross at (304) 877-3900/Ext. 142.

Sincerely,

/S/ JESSE P. COLE

Jesse P. Cole
District Manager
Coal Mine Safety and Health, District 4

cc: Mt. Hope Field Office
Files/dac

SUPERVISORY ACKNOWLEDGEMENT
Initials BR Date 3-23-05
dc 3/23/05

U. S. Department of Labor

Mine Safety and Health Administration
100 Bluestone Road
Mount Hope, WV 25880-1000



MAR 23 2005

Mr. Bill Potter
President
Performance Coal Company
P. O. Box 69
Naoma, WV 25140

Dear Mr. Potter:

Subject: Approved Gas Well Permit, Section 75.1700, 30 CFR 75,
Upper Big Branch Mine-South, I.D. No. 46-08436,
Performance Coal Company, Montcoal, Raleigh County,
West Virginia, Permit No. 17325-T3

This will acknowledge receipt and approval of the subject permit for extracting coal and the request to mine through gas well No. POC 2AA located on the subject mine property.

The permit is based upon an evaluation of the projected mine plan as shown on Form OG-45 dated February 21, 2005, which shows the well being plugged in accordance with the approved 101(c) Petition of Modification and is issued in accordance with provisions of Section 75.1700, 30 CFR.

Should you have any questions concerning this matter, please contact William L. Ross at (304) 877-3900/Ext. 142.

Sincerely,

A handwritten signature in cursive script that reads "Jesse Cole".

Jesse P. Cole
District Manager
Coal Mine Safety and Health, District 4

FROM :WJMHS

FAX NO. :304 558-1282

Mar. 18 2005 12:26PM P3

FORM OG-16

17325 IB

STATE OF WEST VIRGINIA
OFFICE OF MINERS' HEALTH, SAFETY & TRAINING
1615 WASHINGTON ST. EAST
CHARLESTON, WV 25311-2126

PERMIT NUMBER: BOO-850
DATE: 03/08/2005

P E R M I T
TO EXTEND MINE WORKINGS
WITHIN THE 200 FOOT RADIUS OF OIL OR GAS WELLS

COMPANY: PERFORMANCE COAL CO.
MINE: UBBMC MONTCOAL EAGLE
SEAM: EAGLE
DISTRICT: CROOK
COUNTY: RALEIGH
ADDRESS: P O BOX 69
CITY: NAOMA,

MINE PERMIT NUMBER: U00304292

STATE: WV, ZIP: 25140

PERMISSION IS HEREBY GIVEN:

TO MINE INTO AND THROUGH THE NORTH
ENERGY CORP'S PLUGGED GAS WELL NO. POC 2AA LOCATED
ON THE WESTERN POCAHONTAS PROPERTIES LIMITED PART
NERSHIP FARM IN THE CROOK DISTRICT OF BOONE COUNTY
AS SHOWN ON THE APPROVED ATTACHED MAP.

CONTINGENT UPON THE FOLLOWING:

1. MINING IS TO PERFORMED STRICTLY IN ACCORDANCE WITH THE MAP APPROVED BY THE DIVISION OF MINE HEALTH, SAFETY AND TRAINING HERETO.
2. A COPY OF THE PERMIT SHALL BE KEPT AT THE MINE.
3. THE PERMIT IS VOID UPON INSPECTOR'S RECOMMENDATION.
4. THE PERMIT IS NON-TRANSFERRABLE.

WELL OPERATOR: NORTH RIVER ENERGY CORP.
WELL OPERATOR WELL NUMBER: P O C 2 AA
MINE OPERATOR WELL NUMBER: P O C 2 AA

BY: Don Conway
DIRECTOR - WV MINERS' HEALTH,
SAFETY AND TRAINING
Tom Stanley
ADMINISTRATOR - WV MINERS' HEALTH,
SAFETY AND TRAINING

CCS:
NORTH RIVER ENERGY CORP.
REGION: 4
M.S.H.A. District Office
H.S. & T. File



ST. PLUGGING (NO PERMIT #)	JOB NO.	DATE
WELL 2A (ABANDONED)	BY	T. COMER
FOR	DWG. NO.	

POC 2AA

NB3-5-05

EAGLE NB30-835



50' - SURFACE CLASS A
32' BOTTOM 13 3/8" LTS

SPOT CLASS A
800 - SURFACE

736' BOTTOM OF 9 5/8" LTS
SPOT 235 THERMOPLASTIC PLUG
800 - 1085

PERFORATED 1 SHOT 1/2" 820-1085

SET CASPC 1185

PRIMA 2 SLS CAL-SEAL ON 218P
SET 218P 1800 I

1843' BOTTOM OF 7" LTS
1870 - 1840 CLASS A

2920 - 2870 CLASS A

N 3226 TOP OF DAMAGED 2 1/2"

3726 TD

7-Oct-97

SEP 19 1997

API # 47- 5-01322-2

STATE OF WEST VIRGINIA
DIVISION OF ENVIRONMENTAL PROTECTION
SECTION OF OIL AND GAS

AFFIDAVIT OF PLUGGING AND FILLING WELL

AFFIDAVIT SHOULD BE IN TRIPPLICATE, one copy mailed to the Division, one copy to be retained by the Well Operator and the third copy (and extra copies if required) should be mailed to each coal operator at their respective addresses.

Farm name: WESTERN POCAHONTAS CORP. Operator Well No. EUNICE 2-AA
(Original Eunice #2 - plugged initially 9/21/82)

LOCATION: Elevation: 1,852.00 Quadrangle: WHITESVILLE
District: CROOK County: BOONE
Latitude: 700 Feet South of 37 Deg. 55 Min. 0 Sec.
Longitude 7500 Feet West of 81 Deg. 32 Min. 30 Sec.

Well Type: OIL _____ GAS X

Company: Peake Energy, Inc.
P. O. Box 8
Ravenswood, WV 26164

Coal Operator Bethlehem Mines Corp.
or Owner P. O. Box 750
Dunbar, WV 25064

Agent: Thomas S. Liberatore

Coal Operator Western Pocahontas Corp.
or Owner P. O. Box 2827
Huntington, WV 25727

Permit Issued: 10/07/97

AFFIDAVIT

STATE OF WEST VIRGINIA,
County of Boone

ss:

11/3-8-05

Jon Ullom and Mike Wing being first duly sworn according to law depose and say that they are experienced in the work of plugging and filling oil and gas wells and were employed by the above named well operator, and participated in the work of plugging and filling the above well, and Richard Campbell Oil and Gas Inspector representing the Director, say that said work was commenced on the 10th day of November, 1997, and that the well was plugged and filled in the following manner:

TYPE	FROM	TO	PIPE REMOVED	LEFT
Drilled out cement and gel				
to 1210'				
Solid mech. bridge plug	1135'	1133'		
Thixotropic Cement	1133'	635'		
Class A Cement	635'	Surface		
Originally plugged 9/21/82				
Re-plugged to 1135' to meet coal co. requirements				

Description of monument: P. M. Coal Co.
and that the work of plugging and filling said well was completed on the 14th day of November, 1997.

And further deponents saith not.

Sworn and subscribe before me this 22nd day of December, 1997.
My commission expires: March 27, 2001

Michael Ware
Jon Ullom
Notary Public

Oil and Gas Inspector: _____

02-22-05 16:09 NEW RIVER ENERGY



March 26, 1998

Tim Greene
Division of Environmental Protection
#10 McJunkin Road
Nitro, WV 25143-2506

Dear Tim,

Please find enclosed plugging affidavits for the following wells:

<u>Well Name</u>	<u>Number</u>	<u>API</u>
Eunice	8A	5-01436-P ✓
Eunice	7A	5-01522-P
Eunice	3A	5-01420-P
Eunice	2A	5-01383-P
*Eunice	2AA	5-01383-P

**Eunice 2AA was the original Eunice 2A which was plugged on 09/21/82, after casing was lost in the 6 1/4 hole. The drilling rig was skidded and a new hole was drilled. The original "2AA" was re-plugged to 1135' to satisfy coal operator who had purchased the well.*

Please call me at our Ravenswood Office with any questions.

Sincerely,

Jon Ullom
Drilling Supervisor

cc: Richard Campbell

Enclosures

JAU/pld

jonlc/pld

New River Energy Corporation



TO: Mike Milam
FROM: Tim Comer *TEL*
DATE: February 25, 2003
SUBJECT: WELL 047-005-01383 (Eunice #2 -- Peake)

Per our earlier discussion today, this is the wellsite with two wellbores. During drilling, Peake lost a string of 4 1/2" downhole, plugged back, skidded the drill rig over and drilled a new well.

I plugged these on Peake's permit in 1997, using Arrow Well Services. Both bores were plugged to 101-C specs. The "abandoned" well was the one furthest downstream, and the "producing" well was upstream.

I am enclosing copies of my design sketches and the deviation surveys for both bores, and the WR-38 for the "producing" well. I think that, because Peake was the permittee, no WR-38 was filed for the "abandoned" well. However, Mike Wine, who supervised the work for Arrow and signed the WR-38, now manages GasSearch's service rigs and does work for us.

The "abandoned" well was plugged as shown on the design sketch. If you need any further documentation (i.e., a WR-38 for the other bore), give me a call.

Cc: Allen Pettey

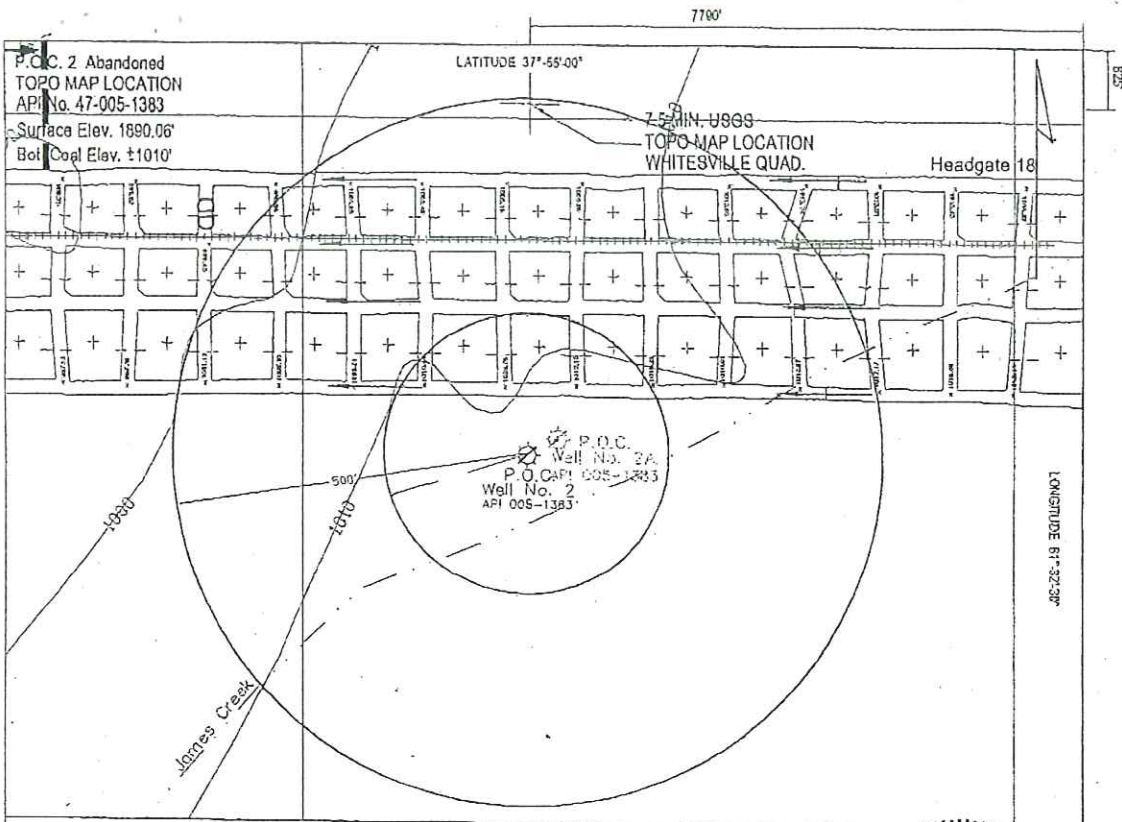

LEGEND

	PROJECTED ROOMS AND ENTRIES
	PROJECTED EXTRACTIONS
	NO SECOND MINING
	ROOMS AND ENTRIES
	PILLAR EXTRACTIONS
	TRACK
	BELT HEAD AND TAIL
	INTAKE AIR
	RETURN AIR
	MAIN FAN

Fig. No. _____
 Drawing No. _____
 Scale 1"=200'
 Minimum degree of accuracy: 1: 7500'

(+) Denotes location of well on United States Topographic Maps

GEORGE T. LEVO
 REGISTERED
 15406
 STATE OF WEST VIRGINIA
 PROFESSIONAL ENGINEER

Signed George T. Levo
 R.P.E. 15406 L.L.S. _____

FORM OG-45
 (REVERSE)
 (09-76)

*800-850
 3-8-05*

Coal Operator's Well Number AA P.O.C. 2 (Abandoned)

Date: February 21, 20 05

Operator's Well No. P.O.C. 2 AA

API Well No. 47 - 005 - 1383
State County Parcel

**COAL OPERATOR'S PLAN TO OPERATE
 WITHIN 200 FEET OR TO MINE THROUGH A WELL**

COAL OPERATOR Performance Coal Company ELEVATIONS: Surface 1890.06
 Address P.O. Box 69 Bottom of Coal ±1010.0
Naoma WV, 25140 Difference +880.06

MINE Upper Big Branch SECTION Longwall # 19 OVERBURDEN SS/SH COAL SEAM Eagle
 ROOF Shale BOTTOM Shale

WELL TYPE: Oil Gas Liquid Injection Waste Disposal
 (If "Gas", Production Underground storage Deep Shallow)

LOCATION: Elevation: 1890.06 Watershed: James Creek of West Fork of Little Coal River
 District: Crook County: Boone Quadrangle: Whitesville
 Farm: Western Pocahontas Tract: 2357 acres (Lease No. 20)
Prosser's Limited Partnership

STATUS: Active Abandoned Drilling
 Date completed or abandoned, September 20, 19 82

AMOUNT OF CASING IN WELL 30' (20"), 763' (9 5/8"), 1843' (7"), & 1993' (4 1/2")

FORM-OG-45
(Obverse)
(Rev. 7-85)



Date: October 27, 2004
Operator's
Well No. POC 2 AA
API Well No. 47 - 005 - 1383
State County Permit

STATE OF WEST VIRGINIA
DEPARTMENT OF ENERGY, DIVISION OF MINES AND MINERALS

COAL OPERATOR'S PETITION TO OPERATE
WITHIN 200 FEET OR TO MINE THROUGH A WELL

WELL TYPE: Oil / Gas X / Liquid Injection / Waste Disposal /
(If "Gas", Production X / Underground storage / Deep / Shallow /

LOCATION: Elevation: 1890.05' Watershed: James Creek of West Fork of Little Coal River

District: Creek County: Boone Quadrangle Whitesville

WELL OPERATOR: North River Energy Corp DESIGNATED AGENT Tim Comer

Address P. O. Box 1867 Address P. O. Box 1867
Charleston, WV 25327 Charleston, WV 25327

The undersigned coal operator hereby petitions for leave to do the following:
 Mine within 200 feet of said well.

X Mine through said well when the same is properly plugged.

On the reverse side hereof is a copy of the map and plan of the undersigned coal operator showing its projected mine workings within 500 feet of said well.

The undersigned coal operator hereby represents that it will file updated or new maps and plans with the Department every six months, until mining within 500 feet of the well has ceased or until the well has been mined through.

Prior to the actual mining through of said well, the undersigned coal operator will submit the Form WR-35, "Well Operator's Report of Drilling, Fracturing and/or Stimulating or Physical Change" and the Form WR-38, "Affidavit of Plugging and Filling Well", to show that the well has been properly plugged in a manner to permit the safe mining through of the well.

Copies of this petition and enclosed maps and plans have been sent by registered mail to the well operator, as required by Code 22A-2-75.

Handwritten: 77 3-8-05

Performance Coal Company

Coal Operator

By George Levo
Its Mining Engineer

STATE OF West Virginia,
COUNTY OF Raleigh, TO WIT:

George T. Levo being first duly sworn, deposes and says that he is Mining Engineer of the coal operator named above; that he is familiar with the facts set out both in the petition and on the accompanying maps and plans; and that the same are true.

George Levo

Subscribed and sworn to before me this February 21, 2005.

My commission expires June 21, 2012

Allen Stithney
Notary Public

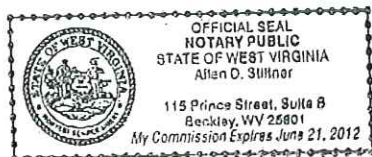

RT3 ENGINEERING

Marfork Coal Company
Elk Run Coal Company
Performance Coal Company

P.O. Box 69
Naoma, WV 25140
Ph: 854-1761
Mining Dept. Fax: 854-3529
Permitting Dept. Fax: 854-3528

FAX

To: Doris Chambers From: George Lewis

Fax: 877-3927 Pages: 7+cover

Phone: _____ Date: 3-18-05

Re: GAS WELL POC 2AA CC: _____

Urgent For Review Please Comment Please Reply Please Recycle

• Comments:

The information transmitted herein may contain confidential, protected health information intended only for the viewing and use of the individual recipient named above. If the reader of this message is not the intended recipient, you are hereby notified that any review, use, communication, dissemination, distribution or copying of this communication is strictly prohibited. If you have received this communication in error, please immediately notify us by telephone at (304) 854-1761 or reply e-mail, delete this message and either destroy or return any printed copies to us at PO Box 69, Naoma, WV 25140 via the U. S. Postal Service. Thank you.